



Frederick County's Septic Pump-Out Rebate Program



FrederickCountyMD.gov/septicrebate



Frederick County Government • Office of the County Executive • Sustainability and Environmental Resources
30 N. Market St. Frederick, MD 21701 • Sustainability@FrederickCountyMD.gov • 301-600-1416





**OFFICE OF SUSTAINABILITY AND ENVIRONMENTAL RESOURCES
FREDERICK COUNTY, MARYLAND**

30 North Market Street • Frederick, Maryland 21701
Phone (301) 600-1416 • Fax (301) 600-2054 <http://www.frederickcountymd.gov>

Septic System Pump-Out Rebate Program

Instructions:

1. Select a licensed septic pumping company that sends its waste to a Frederick County wastewater treatment plant (WWTP).
2. Complete application.
3. Attach a copy of the invoice.
4. Attach a copy of one of the following accepted proofs of payment:
 - Cancelled check (front and back)
 - Credit card receipt
 - Invoice signed by the septic hauler showing account balance of \$0.00
5. Email to sustainability@frederickcountymd.gov or
6. Mail to: Office of Sustainability and Environmental Resources
Attn: Linda Williamson
30 N. Market Street
Frederick, MD 21701

Please Note:

- Rebate processing may take up to 60 days
- There will be a delay in processing if required information is missing or incorrect
- Rebates will be available for homeowners who pump-out their septic systems after January 1, 2018.
- Rebate per pump-out is \$75.00, eligible once every 5 years per address.
- Rebate is subject to funding availability offered on first come, first serve basis.
- Additional costs associated with equipment, parts, upgrades etc. are not eligible for a rebate.

Maintenance Tips:

- Inspect your septic system regularly.
- Pump your septic system every 5 years.
- Do not dispose of hazardous wastes in sinks or toilets.
- Do not drive or park vehicles on top of the drainfield.
- Plant only grass over the drainfield to avoid root damage.





OFFICE OF SUSTAINABILITY AND ENVIRONMENTAL RESOURCES
FREDERICK COUNTY, MARYLAND

30 North Market Street • Frederick, Maryland 21701
Phone (301) 600-1416 • Fax (301) 600-2054 <http://www.frederickcountymd.gov>

FrederickCountyMD.gov/septicrebate
Septic Pump-Out Rebate Application

Please include the following:

☐

Invoice from a licensed pumping company that sends its waste to a Frederick County wastewater treatment plant (WWTP).

☐

Proofs of payment accepted:

- Copy of cancelled check (front and back)

- Copy of credit card receipt

- Copy of invoice signed by the septic hauler showing account balance of \$0.00.

Address of Property (where pump-out occurred):

Applicant Name: _____

Phone Number: _____

E-mail Address: _____

Address to which rebate should be mailed (if different from above):

Verification Statement: *The information submitted is true and accurate to the best of my knowledge. Furthermore, I grant Frederick County the right of enter the property and inspect septic pump-out, if necessary.*

Signature of Property Owner: _____ **Date:** _____

For questions related to this application, please email the Office of Sustainability and Environmental Resources at sustainability@frederickcountymd.gov.

FrederickCountyMD.gov/septicrebate

Tips for Green Leaders -in- FREDERICK COUNTY



Maintaining Your Well and Septic System



Water Conservation Tips

Turn off faucets while shaving or brushing your teeth.

Only run your dishwasher or washing machine with a full load.

Repair leaky faucets, toilets, or pipes.

Landscape using drought-tolerant plants.

Water your garden in the morning or evening when evaporation is lowest.



Septic System Tips

Do!

- Inspect and pump out your system every 5 years.
- Only flush human waste and toilet paper. Ensure all items that are flushed down the septic tank can be broken down by bacteria in the tank.
- Plant only grass over the drainfield.

Do Not!

- Dispose of hazardous wastes in sinks or toilets.
- Use large amounts of bacteria-killing toxins like bleaches, household cleaning products, and disinfectants.
- Drive or park vehicles on top of the drainfield.
- Plant trees or shrubs over the drainfield.



Well Maintenance Tips

Consider the proximity of your well to possible pollution sources. The geology of the area may affect the risk of contamination.

Protect your well from:

- Problems near your well such as flooding, or land disturbances.
- Pollution or animal waste around well head.

Test and inspect your well for:

- Proper Cap
- Damage to casing
- Bacteria each year
- Harmful chemicals every two to three years

Test and inspect your well when:

- You replace or repair part of your well system.
- You notice a change in your well water's taste, color, smell or water quality.

Resources

Environmental Health Services

Frederick County Health Department
350 Montevue Lane
Frederick, MD 21702
(301) 600-1726

Contact your state or local health department to test your water for bacteria, or to get in to contact with a licensed lab in your area that can test for harmful substances

About your Septic System

The septic tank is an underground, watertight container that is usually made with concrete, fiberglass, or polyethylene. It holds wastewater long enough for solids to settle out to form sludge, and oil and grease to float to the surface as scum. It also allows partial decomposition of solid materials.

How does a septic system work?

Compartments and a T-shaped outlet in the septic tank prevent the sludge and scum from leaving the tank and moving into the drainfield area. Wastewater exits the septic tank and is discharged into the drainfield for further treatment by the soil. Microbes in the soil digest or remove most contaminants from wastewater before it reaches the groundwater.

BAT & Septic Tanks

Best Available Technology or BAT units are specifically designed for nitrogen reduction. These units are pre-treated and include electrical and mechanical components such as pumps, blowers, and alarms. BAT units can replace or work in conjunction with an existing septic tank.

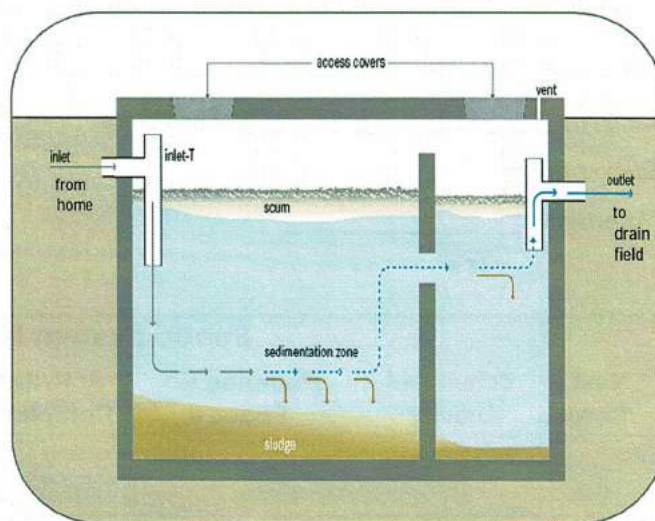

Typical Septic Tank

Responsible Septic System Ownership

If you have a septic system on your property, maintaining it is your responsibility! Proper septic system maintenance such as having your septic system inspected and pumped out every 5 years, has several benefits to the property owner:

- A well-maintained septic system is less likely to break down and require costly repair.
- Maintaining your septic system protects your home investment— if you sell your home, your septic system must be in good working order.
- Maintaining your septic system protects the groundwater and drinking water supply.

Contact your state or local health department to test your water for bacteria, or to get in to contact with a licensed lab in your area that can test for harmful substances.



Public Health
Frederick County Health Department

"Maintaining Your Well and Septic System" is a publication of the Frederick County Office of Sustainability and Environmental Resources, Office of the County Executive. For more information on this program, visit <https://www.frederickcountymd.gov/septicrebate>, email us at sustainability@frederickcountymd.gov, or call at 301.600.1416. Sustainable Frederick County is on Instagram, Twitter, and Facebook.

Homeowner Septic System Checklist

Septic System Description

Date system installed _____

Installer _____

Phone _____

Tank size _____ gallons

Capacity _____ # of bedrooms

Conventional (Y/N) _____

Alternative _____
(Type)

Things that can clog your system:

- "Flushable" Wipes
- Diapers
- Cat litter
- Cigarette filters
- Coffee grounds
- Grease

Things that can kill the bacteria in your system.

- Household chemicals
- Gasoline
- Pesticides
- Antifreeze

Septic System Maintenance Record

Next Service	Scheduled Activity	Pumping Co. Phone #	Activities Completed	Comments
Jan. 2021	Pump-out / Inspection	Joe Pumper 301-555-1234	Pump-out	Joe Pumper suggested replacing riser within 5 years



Environmental Health Services
Frederick County Health Department
350 Montevue Lane
Frederick, Maryland 21702
(301) 600-1726

Draw a sketch of where your septic system is located on your property. This will help your contractors for septic pumping or other issues. It may also be useful when selling your property.

Example Septic Field sketch

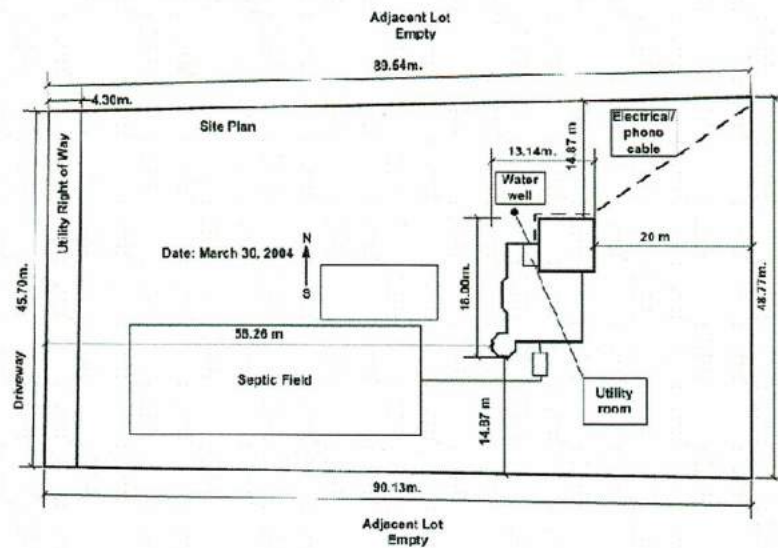

Homeowner Septic sketch

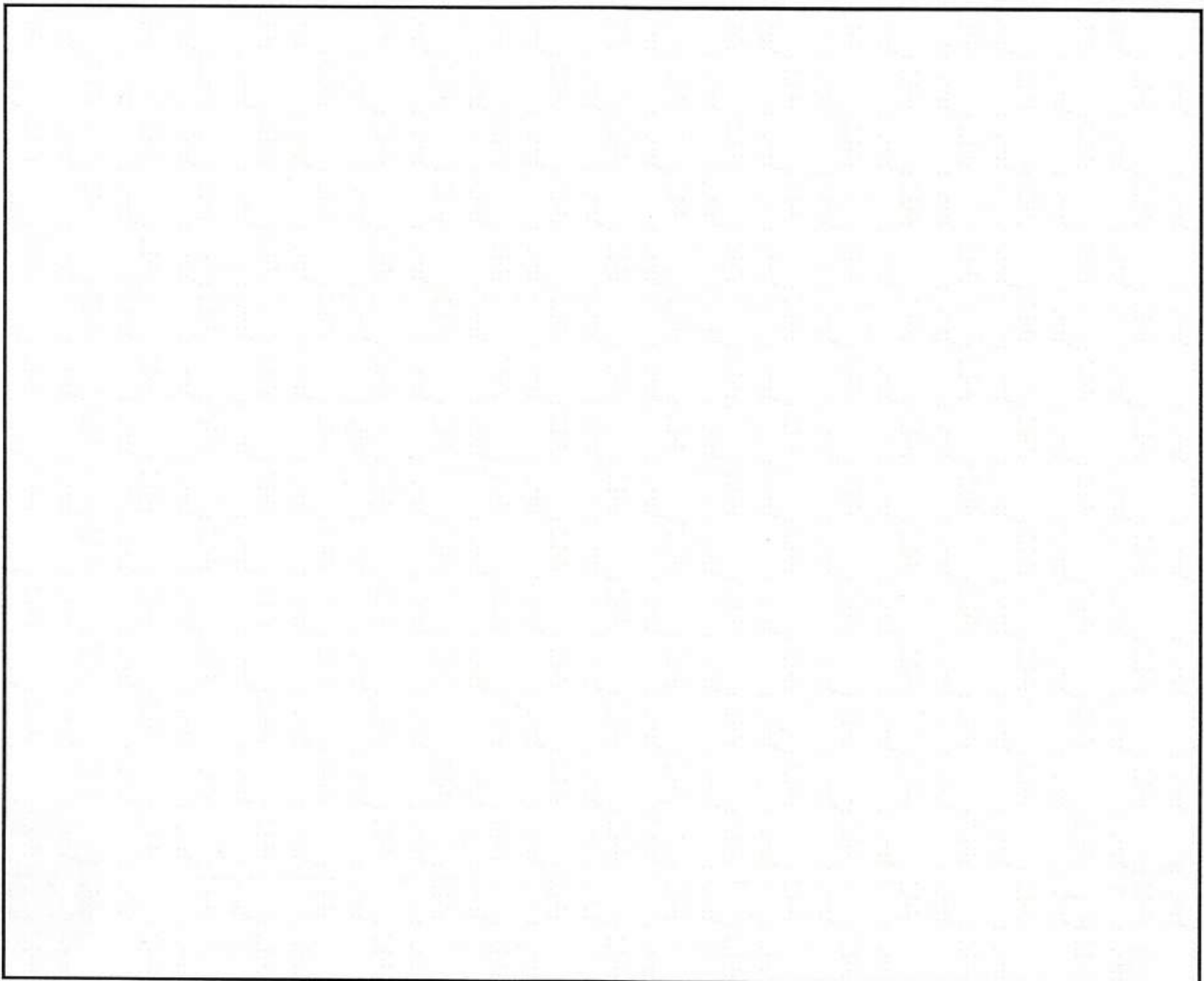



Public Health
Prevent. Promote. Protect.

Frederick County Health Department

Barbara A. Brookmyer, M.D., M.P.H. ▪ Health Officer

Updated July 17, 2019

Re: Pumping of Septic Tanks From the 6
Inch Inspection Port

Dear Liquid Waste Haulers:

It has been brought to the Frederick County Health Department's (FCHD) attention that some liquid waste haulers are routinely using the 6 inch inspection port to pump septic tanks.

The purpose of the 6 inch inspection port is to provide access to the septic tank when a problem occurs and to determine if the problem is between the facility and the septic tank or between the septic tank and the leach field.

The pipe was intentionally sized so that liquid could be pumped from the tank, but only in the case of an emergency. This would allow occupants to continue using sanitary facilities while the problem was being corrected. The 6 inch inspection port is not to be used for routine maintenance of the septic tank.

Every septic tank has an 18"- 24" manhole for routine pumping of the septic tank. This manhole provides sufficient area so that solids can be removed from all areas of the tank. The 6 inch inspection port does not!

As professionals, the FCHD expects you to advise your clients that to correctly remove the solids from the septic tank requires cleaning it from the large manhole.

If the FCHD finds that any waste hauler is telling or implying to their customers that the 6 inch inspection port is to be used for routine removal of solids from the septic tank, your liquid haulers license will be suspended.

If you have any questions or concerns, please contact me at 301-600-3155.

Sincerely,
Kimberly Dillman, Program Manager
Well & Septic Branch

Barry Glotfelty ▪ Director



Environmental Health Services ▪ 350 Montevue Lane ▪ Frederick, MD 21702

Phone: 301-600-1715 ▪ Fax: 301-600-3180 ▪ MD TTY: 1-800-735-2258





Public Health
Prevent. Promote. Protect.

Frederick County Health Department

FREDERICK COUNTY HEALTH DEPARTMENT
Environmental Health Services
350 Montevue Lane Frederick MD 21702
301-600-1726 (information)/301-600-3180 (fax machine)
Email to InformationResearchRequests@FrederickCountyMD.gov

INFORMATION RESEARCH REQUEST FORM

Date _____

This document serves as a formal request for information on the property located at

Street Address _____

Subdivision Name _____

Lot # _____ Section _____ Block _____

Tax Map _____ Parcel _____

Well Identification Tag Number _____ (tag should be attached to well casing)
(if requesting well information)

*****ALL INFORMATION BELOW MUST BE PROVIDED OR REQUEST WILL NOT BE PROCESSED*****

Name of property owner at the time of well and/or septic installation, or at the time of repair or replacement.

It is the requesters responsibility to provide the necessary information for our staff to complete the research. A deed search may be required prior to form submission in order to locate information requested.

Real Property Search <http://sdat.dat.maryland.gov/RealProperty/Pages/default.aspx>

Maryland Deed Search <https://mdlandrec.net/main/index.cfm>

Current Owner's Full Name _____
AND

Previous Owner's Full Name _____ Back to 1950 or year installation occurred

*** (This information must be provided or request will NOT be processed) ***

Provide me with the following information

EXISTING PROPERTY WITH DWELLING

_____ well completion report
_____ existing septic location
_____ bedrooms permitted with current septic system
_____ other (be specific) _____

NEW PROPERTY WITH NO DWELLING

_____ well completion report (for developed property)
_____ proposed septic location (new lots)
_____ total bedrooms allowed (perk results)

Requested by
Name _____
Address _____
Phone (home) _____
(work) _____
(fax) _____

Information to be
_____ picked up in office
_____ faxed
_____ mailed
_____ emailed to

NOTE: Requested information will be returned to you within a **minimum** of ten (10) working days of receipt. A **minimum** of up to 15 working days must be allowed for percolation verification and other technical questions.

NOTE: INCOMPLETE REQUEST FORMS WILL NOT BE PROCESSED.

Frederick County Government		https://www.frederickcountymd.gov/septicrebate		
Haulers Permitted		City / Zip	Phone	Comments
thru 12/31/2019				
Bowman's	H-054	Thurmont MD 21788	443.309.8716	Residential & Commercial
Burns Septic	H-074	Sykesville MD 21784	410.848.2455	Residential Only
Busy Service	H-076	Gaithersburg MD 20882	410.635.8560	Residential & Commercial
Countywide Septic Service (Westminister)	H-053	Keymar MD 21757	240.415.9800	Residential & Commercial
T.E. Crummitt Jr., Backhoe & Septic Service	H-003	New Market Md 21774	301.898.7064	Residential & Commercial
Frederick Septic Co. A Division of D.A. Sensenig Inc.	H-048	Frederick MD 21702	301.698.1033	Residential & Commercial
Freedom Septic Service, Inc.	H-033	Eldersburg, MD 21784	410.795.2947	Residential & Commercial
Fogle's Septic Services	H-005	Sykesville, MD 21784	877.973.7842	Residential & Commercial
Hatfields Septic Service	H-072	Annapolis Jcnctn MD 20701	301.490.4289	Residential & Commercial
Rohrbaugh Septic Cleaning	H-010	Emmitsburg MD. 21727	301-447-2286	Residential & Commercial
Jet Septic	H-042	Westmister MD 21157	410.875.2311	Residential & Commercial
Joseph Renehan / AYS	H-083	Taneytown MD 21787	410.751.1830	Residential & Commercial
Mr. Rooter Plumbing	H-077	Frederick MD 21701	240.435.2304	Residential & Commercial
PM Murphy Septic Services	H-029	Ijamsville MD 21754	301.865.3062	Residential & Commercial
Roelkey's Septic Service	H-009	Knoxville, MD 21758	301.432.5145/ 240.578.1682	Residential & Commercial
Sams Creek	H-089	New Windsor MD 21776	443.821.4932	Residential & Port Toilets
Tri-County Pump Service	H-069	Boonsboro MD 21713	301.432.0330	Residential & Commercial
Tolley Enterprises Inc.	H-085	Monrovia, MD 21770	301.831.6037	Residential Only
WRF & Son Plumbing & Heating Inc.	H-034	Mt Airy MD 21771	301.831.5280	Residential & Commercial
R & E Chiefs Septic LLC	H-068	Mt Airy MD 21771	410.635.3237	Residential
				updated 9-2019



**OFFICE OF SUSTAINABILITY AND ENVIRONMENTAL RESOURCES
FREDERICK COUNTY, MARYLAND**

30 North Market Street • Frederick, Maryland 21701
Phone (301) 600-1416 • Fax (301) 600-2054 <http://www.frederickcountymd.gov>

Septic System Pump-Out Rebate Program

Instructions:

1. Select a licensed septic pumping company that sends its waste to a Frederick County wastewater treatment plant (WWTP).
2. Complete application.
3. Attach a copy of the invoice.
4. Attach a copy of one of the following accepted proofs of payment:
 - Cancelled check (front and back)
 - Credit card receipt
 - Invoice signed by the septic hauler showing account balance of \$0.00
5. Email to sustainability@frederickcountymd.gov or
6. Mail to: Office of Sustainability and Environmental Resources
Attn: Linda Williamson
30 N. Market Street
Frederick, MD 21701

Please Note:

- Rebate processing may take up to 60 days
- There will be a delay in processing if required information is missing or incorrect
- Rebates will be available for homeowners who pump-out their septic systems after January 1, 2018.
- Rebate per pump-out is \$75.00, eligible once every 5 years per address.
- Rebate is subject to funding availability offered on first come, first serve basis.
- Additional costs associated with equipment, parts, upgrades etc. are not eligible for a rebate.

Maintenance Tips:

- Inspect your septic system regularly.
- Pump your septic system every 5 years.
- Do not dispose of hazardous wastes in sinks or toilets.
- Do not drive or park vehicles on top of the drainfield.
- Plant only grass over the drainfield to avoid root damage.





OFFICE OF SUSTAINABILITY AND ENVIRONMENTAL RESOURCES
FREDERICK COUNTY, MARYLAND

30 North Market Street • Frederick, Maryland 21701
Phone (301) 600-1416 • Fax (301) 600-2054 <http://www.frederickcountymd.gov>

FrederickCountyMD.gov/septicrebate
Septic Pump-Out Rebate Application

Please include the following:

☐

Invoice from a licensed pumping company that sends its waste to a Frederick County wastewater treatment plant (WWTP).

☐

Proofs of payment accepted:

- Copy of cancelled check (front and back)

- Copy of credit card receipt

- Copy of invoice signed by the septic hauler showing account balance of \$0.00.

Address of Property (where pump-out occurred):

Applicant Name: _____

Phone Number: _____

E-mail Address: _____

Address to which rebate should be mailed (if different from above):

Verification Statement: *The information submitted is true and accurate to the best of my knowledge. Furthermore, I grant Frederick County the right of enter the property and inspect septic pump-out, if necessary.*

Signature of Property Owner: _____ **Date:** _____

For questions related to this application, please email the Office of Sustainability and Environmental Resources at sustainability@frederickcountymd.gov.

FrederickCountyMD.gov/septicrebate

Frederick County Government		https://www.frederickcountymd.gov/septicrebate		
Haulers Permitted		City / Zip	Phone	Comments
thru 12/31/2019				
Bowman's	H-054	Thurmont MD 21788	443.309.8716	Residential & Commercial
Burns Septic	H-074	Sykesville MD 21784	410.848.2455	Residential Only
Busy Service	H-076	Gaithersburg MD 20882	410.635.8560	Residential & Commercial
Countywide Septic Service (Westminister)	H-053	Keymar MD 21757	240.415.9800	Residential & Commercial
T.E. Crummitt Jr., Backhoe & Septic Service	H-003	New Market Md 21774	301.898.7064	Residential & Commercial
Frederick Septic Co. A Division of D.A. Sensenig Inc.	H-048	Frederick MD 21702	301.698.1033	Residential & Commercial
Freedom Septic Service, Inc.	H-033	Eldersburg, MD 21784	410.795.2947	Residential & Commercial
Fogle's Septic Services	H-005	Sykesville, MD 21784	877.973.7842	Residential & Commercial
Hatfields Septic Service	H-072	Annapolis Jnctn MD 20701	301.490.4289	Residential & Commercial
Rohrbaugh Septic Cleaning	H-010	Emmitsburg MD. 21727	301-447-2286	Residential & Commercial
Jet Septic	H-042	Westmister MD 21157	410.875.2311	Residential & Commercial
Joseph Renehan / AYS	H-083	Taneytown MD 21787	410.751.1830	Residential & Commercial
Mr. Rooter Plumbing	H-077	Frederick MD 21701	240.435.2304	Residential & Commercial
PM Murphy Septic Services	H-029	Ijamsville MD 21754	301.865.3062	Residential & Commercial
Roelkey's Septic Service	H-009	Knoxville, MD 21758	301.432.5145/ 240.578.1682	Residential & Commercial
Sams Creek	H-089	New Windsor MD 21776	443.821.4932	Residential & Port Toilets
Tri-County Pump Service	H-069	Boonsboro MD 21713	301.432.0330	Residential & Commercial
Tolley Enterprises Inc.	H-085	Monrovia, MD 21770	301.831.6037	Residential Only
WRF & Son Plumbing & Heating Inc.	H-034	Mt Airy MD 21771	301.831.5280	Residential & Commercial
R & E Chiefs Septic LLC	H-068	Mt Airy MD 21771	410.635.3237	Residential
				updated 9-2019



Public Health
Prevent. Promote. Protect.

Frederick County Health Department

Barbara A. Brookmyer, M.D., M.P.H. ▪ Health Officer

Updated July 17, 2019

Re: Pumping of Septic Tanks From the 6
Inch Inspection Port

Dear Liquid Waste Haulers:

It has been brought to the Frederick County Health Department's (FCHD) attention that some liquid waste haulers are routinely using the 6 inch inspection port to pump septic tanks.

The purpose of the 6 inch inspection port is to provide access to the septic tank when a problem occurs and to determine if the problem is between the facility and the septic tank or between the septic tank and the leach field.

The pipe was intentionally sized so that liquid could be pumped from the tank, but only in the case of an emergency. This would allow occupants to continue using sanitary facilities while the problem was being corrected. The 6 inch inspection port is not to be used for routine maintenance of the septic tank.

Every septic tank has an 18"- 24" manhole for routine pumping of the septic tank. This manhole provides sufficient area so that solids can be removed from all areas of the tank. The 6 inch inspection port does not!

As professionals, the FCHD expects you to advise your clients that to correctly remove the solids from the septic tank requires cleaning it from the large manhole. If the FCHD finds that any waste hauler is telling or implying to their customers that the 6 inch inspection port is to be used for routine removal of solids from the septic tank, your liquid haulers license will be suspended.

If you have any questions or concerns, please contact me at 301-600-3155.

Sincerely,
Kimberly Dillman, Program Manager
Well & Septic Branch

Barry Glotfelty ▪ Director

Environmental Health Services ▪ 350 Montevue Lane ▪ Frederick, MD 21702
Phone: 301-600-1715 ▪ Fax: 301-600-3180 ▪ MD TTY: 1-800-735-2258

